

GROUP 2 SPECIFICATIONS

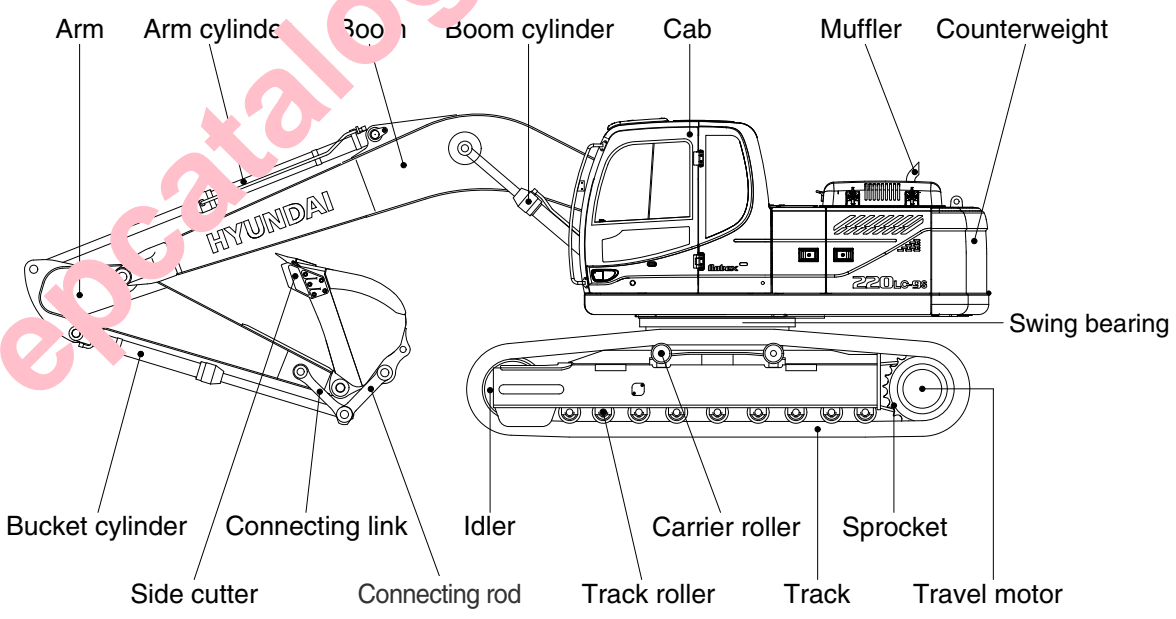
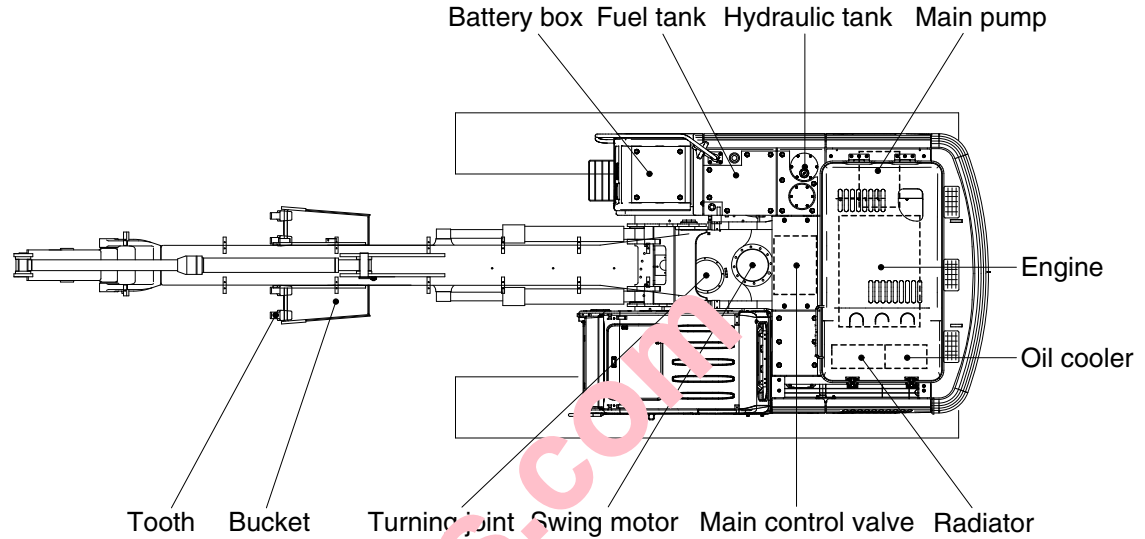

2209S2SP01

2. SPECIFICATIONS

1) R220LC-9S

- 5.68 m (18' 8") BOOM and 2.92 m (9' 7") ARM

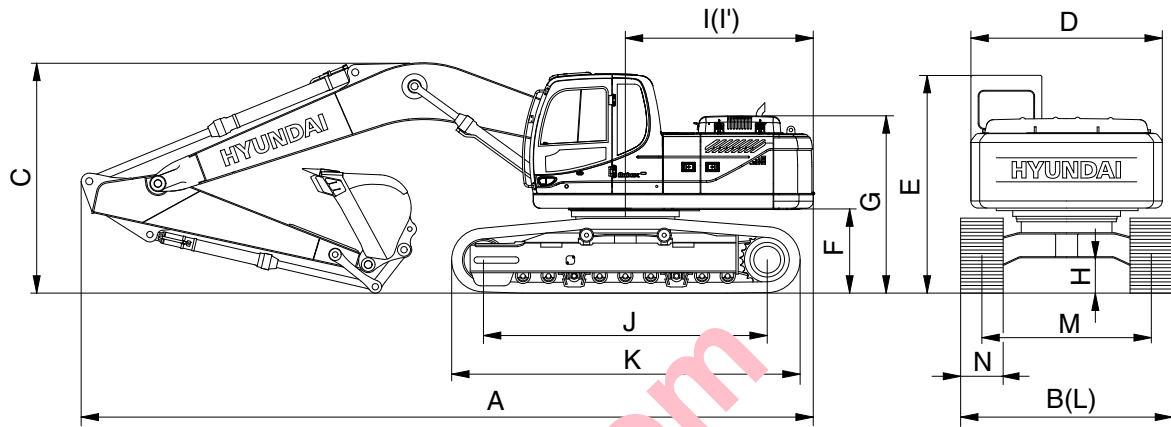

21092SP02

Description	Unit	Specification
Operating weight	kg (lb)	21900 (48280)
Bucket capacity (SAE heaped), standard	m ³ (yd ³)	0.92 (1.20)
Overall length	A	9530 (31' 3")
Overall width, with 600mm shoe	B	2990 (9' 10")
Overall height	C	3030 (9' 11")
Superstructure width	D	2740 (9' 0")
Overall height of cab	E	3000 (9' 10")
Ground clearance of counterweight	F	1060 (3' 6")
Engine cover height	G	2320 (7' 7")
Minimum ground clearance	H	480 (1' 7")
Rear-end distance	I	2770 (9' 1")
Rear-end swing radius	I'	2840 (9' 4")
Distance between tumblers	J	3650 (12' 0")
Undercarriage length	K	4440 (14' 7")
Undercarriage width	L	2990 (9' 10")
Track gauge	M	2390 (7' 10")
Track shoe width, standard	N	600 (24")
Travel speed (low/high)	km/hr (mph)	3.8/5.5 (2.4/3.4)
Swing speed	rpm	11.1
Gradeability	Degree (%)	35 (70)
Ground pressure (600 mm shoe)	kgf/cm ² (psi)	0.46 (6.54)
Max traction force	kg (lb)	21100 (46500)

2) R220LC-9S LONG REACH

- 8.2 m (26' 11") BOOM and 6.3 m (20' 8") ARM

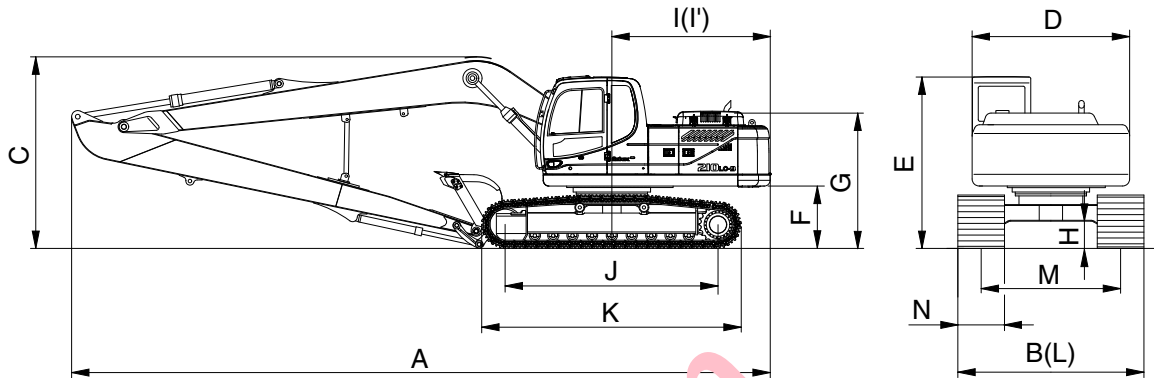

21092SP06

Description	Unit	Specification
Operating weight	kg (lb)	24360 (53700)
Bucket capacity (SAE heaped), standard	m ³ (yd ³)	0.52 (0.68)
Overall length		12030 (39' 6")
Overall width, with 800 mm shoe	B	3190 (10' 6")
Overall height	C	3280 (10' 9")
Superstructure width	D	2740 (9' 0")
Overall height of cab	E	3000 (9' 10")
Ground clearance of counterweight	F	1060 (3' 6")
Engine cover height	G	2320 (7' 7")
Minimum ground clearance	H	480 (1' 7")
Rear-end distance	I	2770 (9' 1")
Rear-end swing radius	I'	2840 (9' 4")
Distance between tumblers	J	3650 (12' 0")
Undercarriage length	K	4440 (14' 7")
Undercarriage width	L	3190 (10' 6")
Track gauge	M	2390 (7' 10")
Track shoe width, standard	N	800 (32")
Travel speed (low/high)	km/hr (mph)	3.8/5.5 (2.4/3.4)
Swing speed	rpm	11.1
Gradeability	Degree (%)	35 (70)
Ground pressure (800 mm shoe)	kgf/cm ² (psi)	0.42 (5.97)
Max traction force	kg (lb)	21100 (46500)

3) R220LC-9S HIGH WALKER

- 5.68 m (18' 8") BOOM and 2.92 m (9' 7") ARM

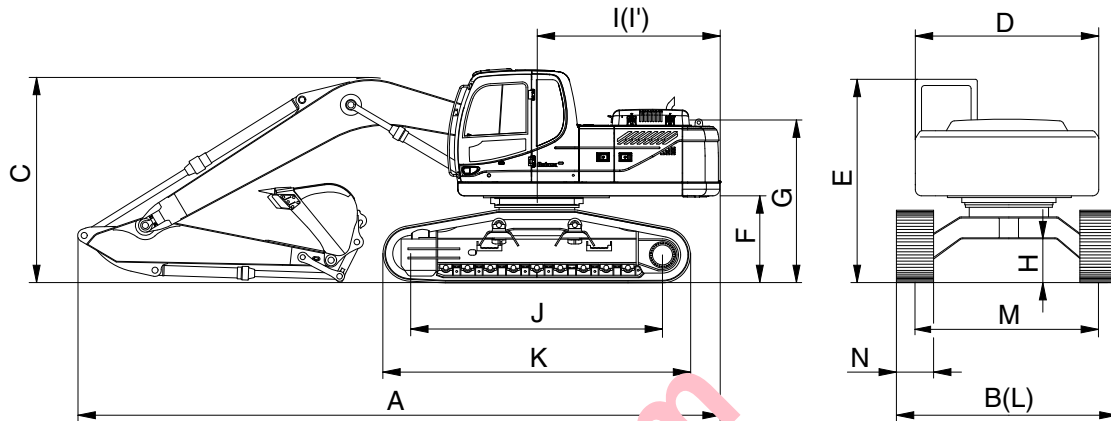

21092SP07

Description	Unit	Specification
Operating weight	kg (lb)	23160 (51060)
Bucket capacity (SAE heaped), standard	m ³ (yd ³)	0.92 (1.20)
Overall length		9470 (31' 1")
Overall width, with 600 mm shoe	B	3395 (11' 2")
Overall height	C	3060 (10' 0")
Superstructure width	D	2740 (9' 0")
Overall height of cab	E	3100 (10' 2")
Ground clearance of counterweight	F	1240 (4' 1")
Engine cover height	G	2500 (8' 2")
Minimum ground clearance	H	660 (2' 2")
Rear end distance	I	2770 (9' 1")
Rear-end swing radius	I'	2840 (9' 4")
Distance between tumblers	J	3650 (12' 0")
Undercarriage length	K	4440 (14' 7")
Undercarriage width	L	3395 (11' 2")
Track gauge	M	2795 (9' 2")
Track shoe width, standard	N	600 (24")
Travel speed (low/high)	km/hr (mph)	3.8/5.5 (2.4/3.4)
Swing speed	rpm	11.1
Gradeability	Degree (%)	35 (70)
Ground pressure (600 mm shoe)	kgf/cm ² (psi)	0.49 (6.97)
Max traction force	kg (lb)	21100 (46500)

3. WORKING RANGE

1) R220LC-9S

· 5.68 m (18' 8") BOOM

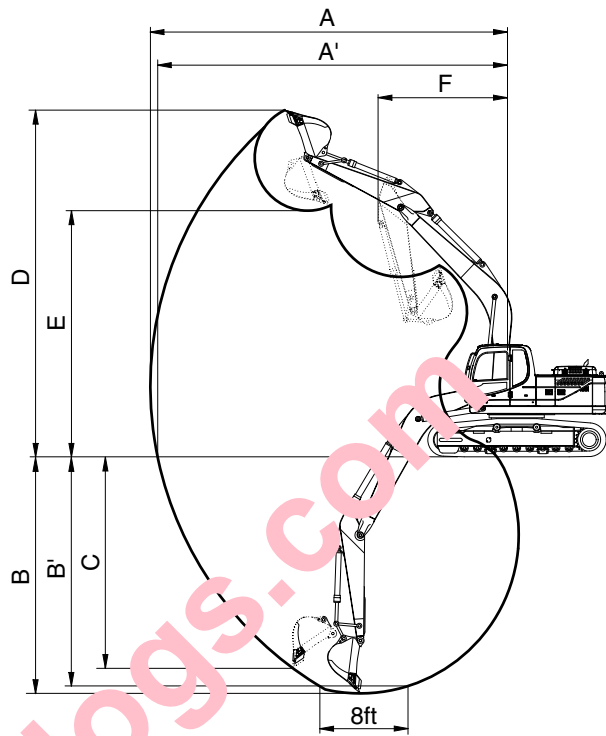

21092SP03

Description		2.0 m (6' 7") Arm	2.40 m (7' 10") Arm	2.92 m (9' 7") Arm	3.90 m (12' 10") Arm
Max digging reach	A	9140 mm (30' 0")	9500 mm (31' 2")	9980 mm (32' 9")	10910 mm (35' 10")
Max digging reach on ground	A'	8960 mm (29' 5")	9330 mm (30' 7")	9820 mm (32' 3")	10770 mm (35' 4")
Max digging depth	B	5820 mm (19' 1")	6220 mm (20' 5")	6730 mm (22' 1")	7720 mm (25' 4")
Max digging depth (8 ft level)	B'	5580 mm (18' 4")	6010 mm (19' 9")	6560 mm (21' 6")	7580 mm (24' 10")
Max vertical full digging depth	C	5280 mm (17' 4")	5720 mm (18' 9")	6280 mm (20' 7")	7240 mm (23' 9")
Max dumping height	D	9140 mm (30' 0")	9340 mm (30' 8")	9600 mm (31' 6")	10110 mm (33' 2")
Max dumping height	E	6330 mm (20' 9")	6520 mm (21' 5")	6780 mm (22' 3")	7290 mm (23' 11")
Min swing radius	F	3750 mm (12' 4")	3740 mm (12' 3")	3740 mm (12' 3")	3650 mm (12' 0")
Bucket digging force	SAE	133.4 [144.8] kN	133.4 [144.8] kN	133.4 [144.8] kN	133.4 [144.8] kN
		13600 [14770] kgf	13600 [14770] kgf	13600 [14770] kgf	13600 [14770] kgf
		29980 [32550] lbf	29980 [32550] lbf	29980 [32550] lbf	29980 [32550] lbf
	ISO	152.0 [165.0] kN	152.0 [165.0] kN	152.0 [165.0] kN	152.0 [165.0] kN
		15500 [16830] kgf	15500 [16830] kgf	15500 [16830] kgf	15500 [16830] kgf
		34170 [37100] lbf	34170 [37100] lbf	34170 [37100] lbf	34170 [37100] lbf
Arm digging force	SAE	144.2 [156.5] kN	119.6 [129.9] kN	102.0 [110.7] kN	84.3 [91.6] kN
		14700 [15960] kgf	12200 [13250] kgf	10400 [11290] kgf	8600 [9340] kgf
		32410 [35190] lbf	26900 [29210] lbf	22930 [24900] lbf	18960 [20590] lbf
	ISO	151.0 [164.0] kN	125.5 [136.3] kN	106.9 [116.1] kN	87.3 [94.8] kN
		15400 [16720] kgf	12800 [13900] kgf	10900 [11830] kgf	8900 [9660] kgf
		33950 [36860] lbf	28220 [30640] lbf	24030 [26090] lbf	19620 [21300] lbf

[] : Power boost

[Buy now](#)

[Hyundai Crawler Excavator R220LC-9S \(Brazil\) Service Manual PDF](#)

[With Instant Download](#)